

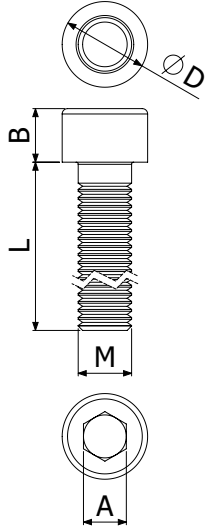

CHARACTERISTICS



Models: M8x55; M8x70; M10x30.

Finishes: EZ, ss304.

Characteristics:

- Rounded head without edges
- Hexagonal hollow head (allen key).

Dimensions:

MODEL	M(mm)	L (mm)	D (mm)	A (mm)	B (mm)	T (N-m)
M8x55	8	55	13	6	8	15
M8x70	8	70	13	6	8	15
M10x30	10	30	16	8	10	35

USE INSTRUCTIONS

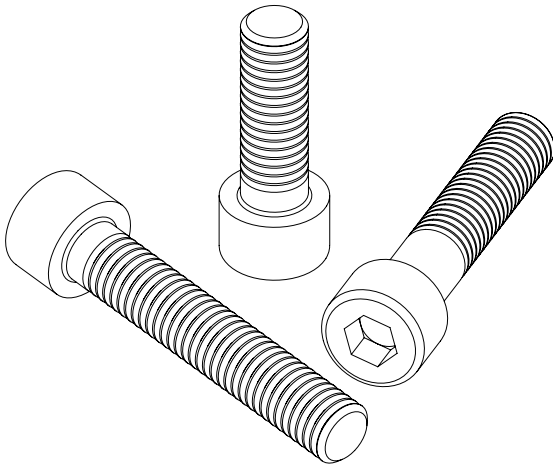

- Bolt M10x30 DIN 912 is used to mount the profiles and accessories of the BASORPERFIL 41/82 family together with spring nut or DIN 934 nut when the bolt head is inside the profile and therefore can not be accessed with the usual tools and a hex head bolt (DIN 933) would be required.
- Bolt M8x55 is used with M8 spring nut for the fixing of solar panels to profile 41x41 when central junction solar panels (2/6794) are used.
- Bolt M8x70 is used with M8 spring nut for securing solar panels to profile 41x41 when side junction solar panels (2/6795) are used.